

NOTES:

- 1. SUBSTRATE: Fused Silica (Corning 7980)
- 2. ROHS: COMPLIANT
- 3. SURFACE S2 TO BE PARALLEL TO SURFACE S1 TO WITHIN <5 ARCMIN
- 4. COATING (APPLY ACROSS CLEAR APERTURE)

$S1 \& S2: R(AVG) \leq 0.4\% @ 425 - 675nm$

- 5. TRANSMITTED WAVEFRONT DISTORTION: $\leq 1\lambda$

6. FINE GRIND SURFACE

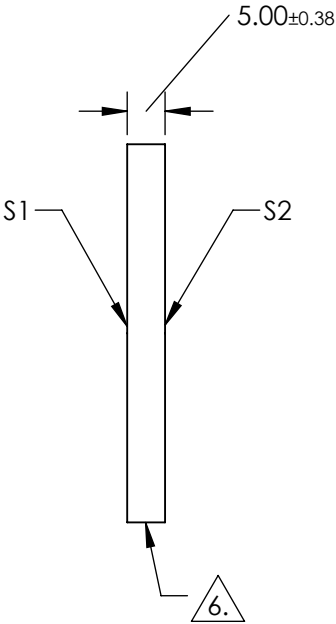
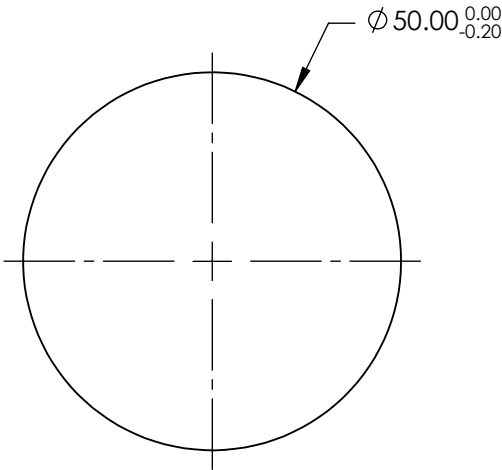

**FOR INFORMATION ONLY:
DO NOT MANUFACTURE
PARTS TO THIS DRAWING**

SPECIFICATIONS SUBJECT TO CHANGE WITHOUT NOTICE
DIMENSIONS ARE FOR REFERENCE ONLY

	S1	S2
SHAPE	PLANO	PLANO
SURFACE QUALITY	60-40	60-40
CLEAR APERTURE	Ø 45.00	Ø 45.00
BEVEL	PROTECTED AS NEEDED	PROTECTED AS NEEDED

THIRD ANGLE
PROJECTION

ALL DIMS IN mm

Edmund Optics®

TITLE	50mm Dia., 5mm Thick VIS 0° Coated, 1λ Fused Silica Window
DWG NO	19897
SHEET	1 OF 1