

NOTES:

1. SUBSTRATE:
FUSED SILICA
2. ROHS COMPLIANT

3. COATING (APPLY ACROSS CLEAR APERTURE)

S1 & S2: VIS-NIR (400-1000nm)
R(ABS) $\leq 0.25\%$ @ 880nm
R(AVG) $\leq 1.25\%$ @ 400 - 870nm
R(AVG) $\leq 1.25\%$ @ 890 - 1000nm

4. FINE GRIND SURFACE (ADD INK NOTE AS NEEDED)

5. FINE GRIND SURFACE

6. FOCAL LENGTH (EFL): -13.5mm
BACK FOCAL LENGTH (BFL): -14.89mm

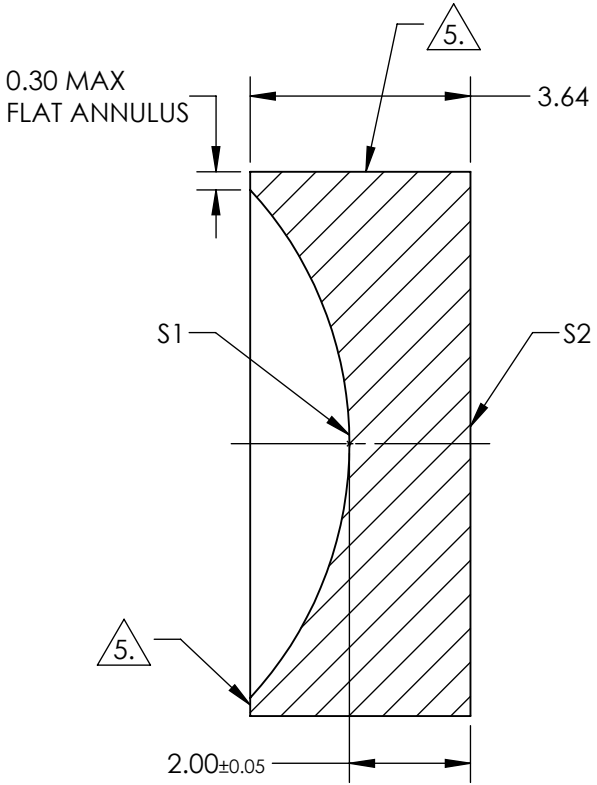
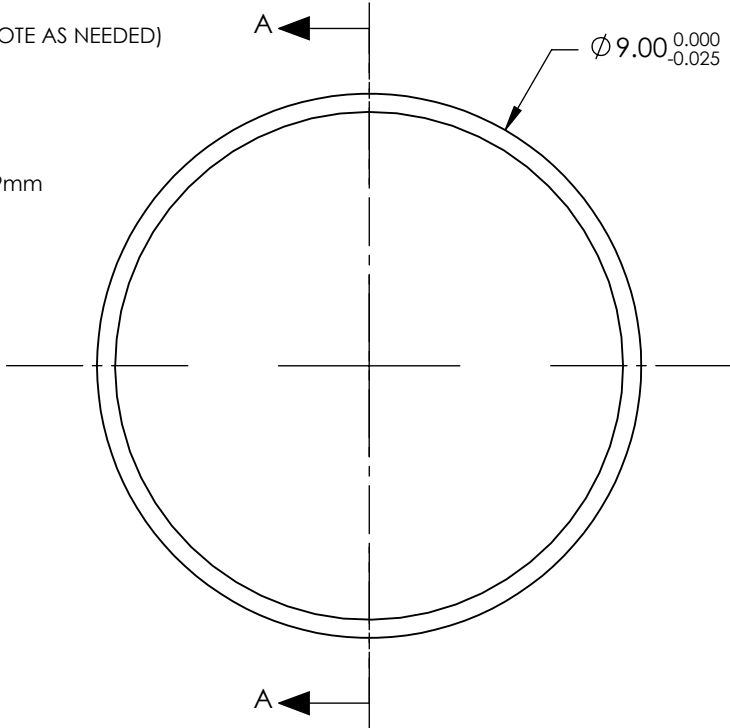

FOR INFORMATION ONLY:
DO NOT MANUFACTURE
PARTS TO THIS DRAWING

SPECIFICATIONS SUBJECT TO CHANGE WITHOUT NOTICE
DIMENSIONS ARE FOR REFERENCE ONLY

| | S1 | S2 |
|-----------------|---------------------|---------------------|
| SHAPE | CONCAVE | PLANO |
| RADIUS | -6.20 | INFINITY |
| SURFACE QUALITY | 40-20 | 40-20 |
| CLEAR APERTURE | Ø 8.1 | Ø 8.1 |
| BEVEL | PROTECTED AS NEEDED | PROTECTED AS NEEDED |

THIRD ANGLE
PROJECTION

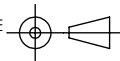

ALL DIMS IN

mm



Edmund Optics®

TITLE

9.0mm Dia. x -13.5 FL, VIS-NIR, UV Plano-
Concave Lens

DWG NO

21046

SHEET
1 OF 1