

NOTES:

- 1. SUBSTRATE: UV FUSED SILICA
- 2. COATING SPEC (APPLY ACROSS CLEAR APERTURE):

S1 & S2: R(ABS) <0.25% @ 355nm @ 0°AOI

3. FINE GRIND SURFACE

4. POWER, IRREGULARITY, AND SURFACE QUALITY SPECIFICATIONS
APPLY ACROSS CLEAR APERTURE

5. ROHS COMPLIANT

FOR INFORMATION ONLY:
DO NOT MANUFACTURE
PARTS TO THIS DRAWING

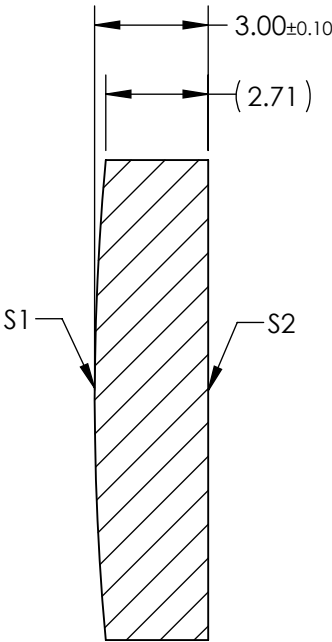
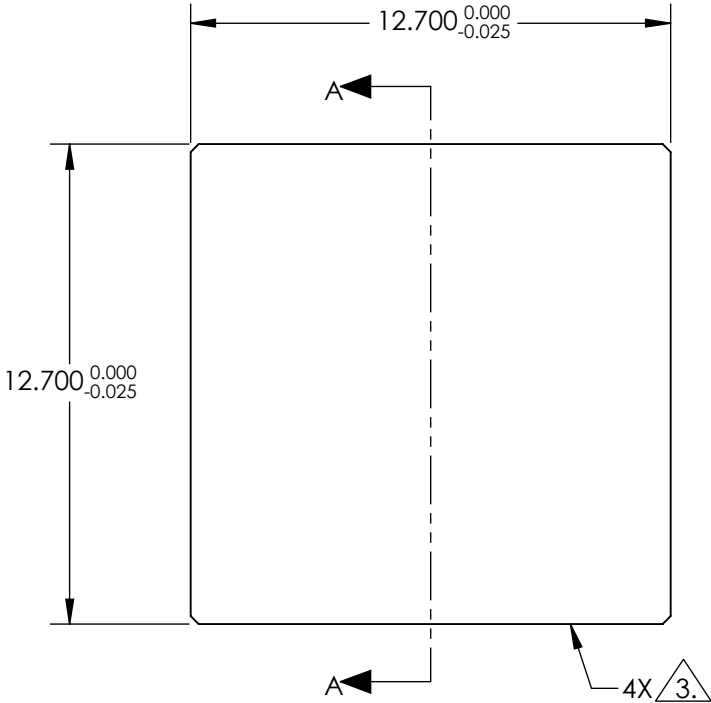

SECTION A-A

SPECIFICATIONS SUBJECT TO CHANGE WITHOUT NOTICE
DIMENSIONS ARE FOR REFERENCE ONLY

	S1	S2
SHAPE	CONCAVE	INFINITY
SURFACE QUALITY	20-10	20-10
CLEAR APERTURE	11.43 x 11.43	11.43 x 11.43
BEVEL	PROTECTIVE AS NEEDED	PROTECTIVE AS NEEDED

THIRD ANGLE
PROJECTION

ALL DIMS IN mm

Edmund Optics®

TITLE	12.7mm Square x 150 FL, 355nm AR Coated, Laser Grade PCX Cylinder Lens		
DWG NO	13479	SHEET 1 OF 1	