

FOCAL LENGTH (EFL): 200 ±2

BACK FOCAL LENGTH (BFL): 197,89



LEFT SURFACE AR COATING:

NIR II

$R(ABS) \leq 1,5\%$ FROM 750-800nm @ 0° AOI

$R(ABS) \leq 1,0\%$ FROM 800-1550nm @ 0° AOI

$R(AVG) \leq 0,7\%$ FROM 750-1550nm @ 0° AOI

RIGHT SURFACE AR COATING:

NIR II

$R(ABS) \leq 1,5\%$ FROM 750-800nm @ 0° AOI

$R(ABS) \leq 1,0\%$ FROM 800-1550nm @ 0° AOI

$R(AVG) \leq 0,7\%$ FROM 750-1550nm @ 0° AOI

LEFT SURFACE		MATERIAL	RIGHT SURFACE	
R	103,36 CX	GLASS N-BK7 Nd: 1,517 Vd: 64,2	R	∞ PL
Øe	14		Øe	14
3/	3 (0,5) λ=632,8 nm		3/	3 (0,5) λ=632,8 nm
4/	-		4/	1,93'
5/	40 - 20		5/	40 - 20
6/	-		6/	-

PROTECTIVE CHAMFERS AS NEEDED

ROHS:
COMPLIANT

SCALE:
NONE

λ = 587,6nm

FIRST ANGLE
PROJECTION

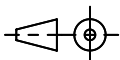

ALL DIMS
IN:

mm



Edmund Optics®

TITLE

15mm Dia x 200mm FL, NIR II Coated,
Plano-Convex Lens

DWG NO

14378

SHEET
SIZE A4

SHEET
1 OF 1

SPECIFICATIONS SUBJECT TO CHANGE WITHOUT
NOTICE. DIMENSIONS ARE FOR REFERENCE ONLY

FOR INFORMATION ONLY: DO NOT MANUFACTURE
PARTS TO THIS DRAWING

INDICATIONS IN ACCORDANCE WITH ISO 10110