

- NOTES:
- 1. SUBSTRATE: B270
 - 2. RoHS: COMPLIANT
 - 3. SURFACE S2 TO BE PARALLEL TO SURFACE S1 TO WITHIN < 4 arcmin
 - 4. S1 & S2:
AR: Ravg <0.5% @ 400 - 700nm

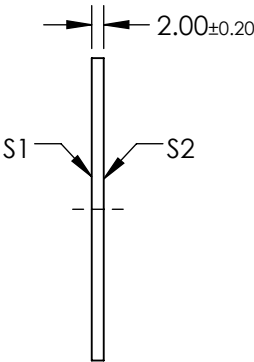
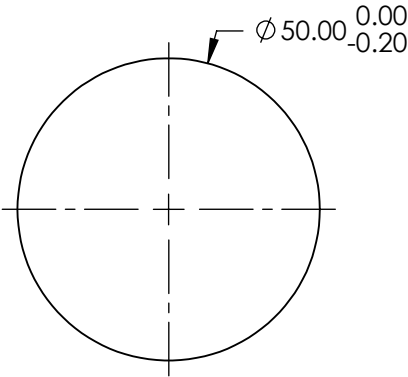
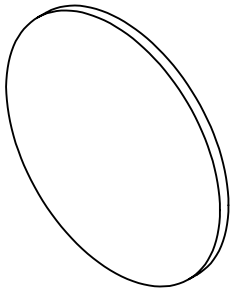

FOR INFORMATION ONLY:
DO NOT MANUFACTURE
PARTS TO THIS DRAWING

SPECIFICATIONS SUBJECT TO CHANGE WITHOUT NOTICE
DIMENSIONS ARE FOR REFERENCE ONLY

| | |
|----------------------------|-------------------------------------|
| REV. A | |
| EXTINCTION RATIO | 10000 |
| OPERATING TEMPERATURE (°C) | -25 to +65 |
| SURFACE FLATNESS | <1λ |
| TRANSMISSION | 25% @ ±2% (for random polarization) |

THIRD ANGLE
PROJECTION

ALL DIMS IN mm

| | | | |
|--|---|--------------|--|
|  Edmund Optics® | | | |
| TITLE | 50mm DIA. HIGH PERFORMANCE LINEAR GLASS POLARIZER | | |
| DWG NO | 47217 | SHEET 1 OF 1 | |