

NOTES:

- 1. REMOVABLE LEVER: M1.7 x 0.35 THREAD
- 2. MATERIALS
  - HOUSING: BRASS (BLACK)
  - LEAVES: BLACK SPRING STEEL
  - LEVER: STEEL

FOR INFORMATION ONLY:  
DO NOT MANUFACTURE  
PARTS TO THIS DRAWING

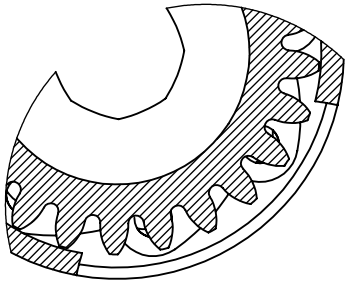
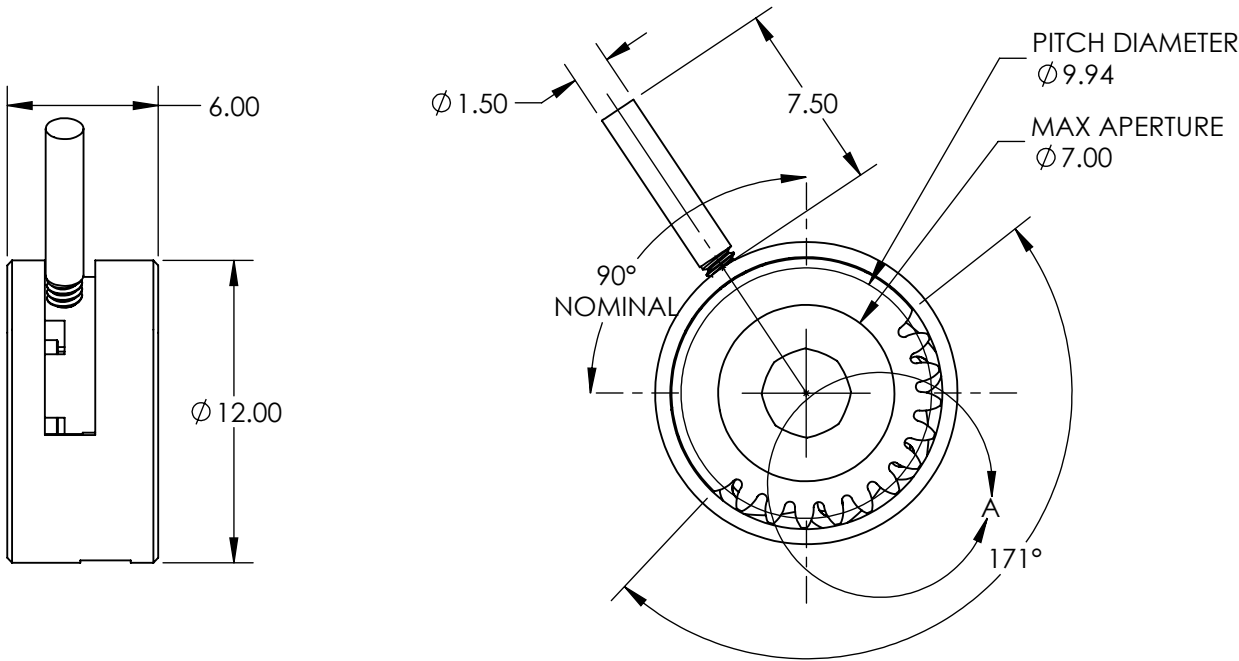

DETAIL A

SPECIFICATIONS SUBJECT TO CHANGE WITHOUT NOTICE  
DIMENSIONS ARE FOR REFERENCE ONLY

**Edmund Optics®**

REV. A	VALUE
MIN APERTURE	Ø0.7mm
GEAR WHEEL MODULE	0.4

THIRD ANGLE PROJECTION		TITLE	7mm MAX APERTURE MOTORIZABLE IRIS	
ALL DIMS IN	mm	DWG NO	34286	SHEET 1 OF 1