

- NOTES:
- 1. SUBSTRATE:  
FUSED SILICA
  - 2. COATING (APPLY ACROSS COATING APERTURE):  
  
S1:  $R(AVG) \geq 98\%$  @ 340-488nm @ 0° AOI  
 $R(AVG) \geq 98\%$  @ 320-450nm @ 45° AOI FOR ALL POLARIZATION  
 $R(AVG) \geq 98\%$  @ 320-450nm @ 45° FOR S-POLARIZATION  
  
S2: NONE

3. FINE GRIND SURFACE

FOR INFORMATION ONLY:  
DO NOT MANUFACTURE  
PARTS TO THIS DRAWING

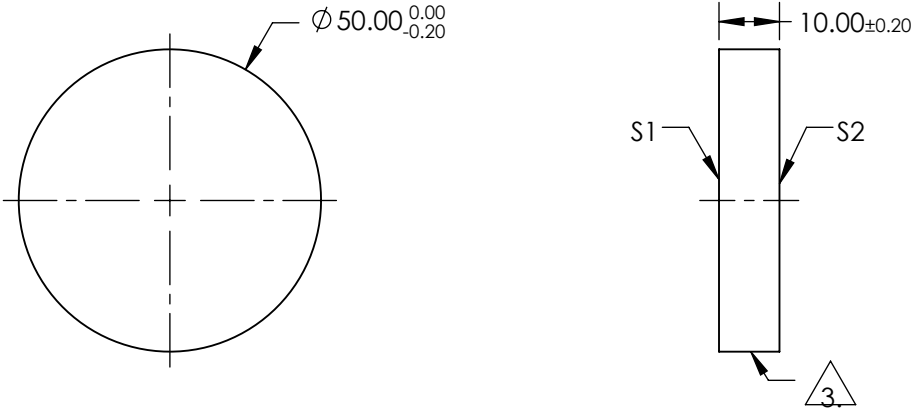

SPECIFICATIONS SUBJECT TO CHANGE WITHOUT NOTICE  
DIMENSIONS ARE FOR REFERENCE ONLY

	S1	S2
SHAPE	PLANO	PLANO
CLEAR APERTURE	> 90	N/A
SURFACE QUALITY	20-10	FINE GRIND
SURFACE FLATNESS	$\lambda/10$	N/A
BEVEL	PROTECTIVE AS NEEDED	PROTECTIVE AS NEEDED

THIRD ANGLE PROJECTION		Edmund Optics®	
ALL DIMS IN		TITLE	Ø50mm, 320 - 450nm BROADBAND $\lambda/10$ MIRROR
mm		DWG NO	37571
			SHEET 1 OF 1