

NOTES:

- 1. COATING (APPLY ACROSS CLEAR APERTURE)
LASER V-COAT
R(abs) 0.25% @ 1064 nm
- 2. RoHS COMPLIANT

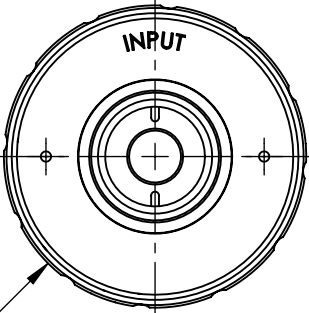
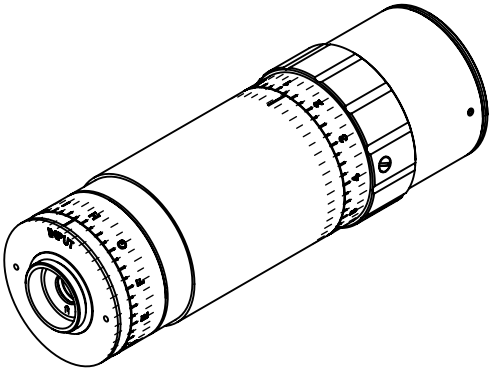
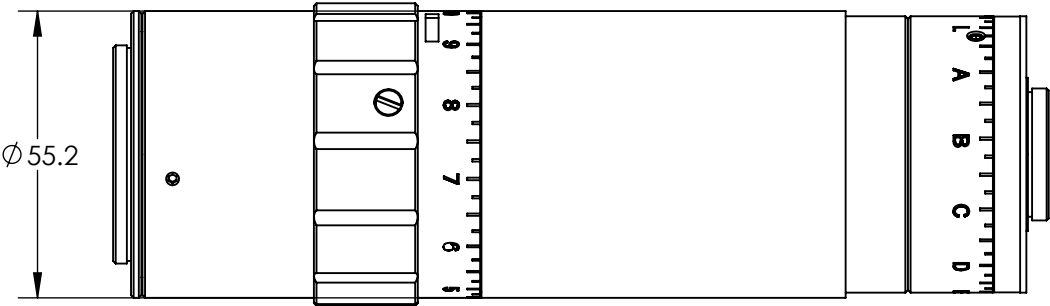
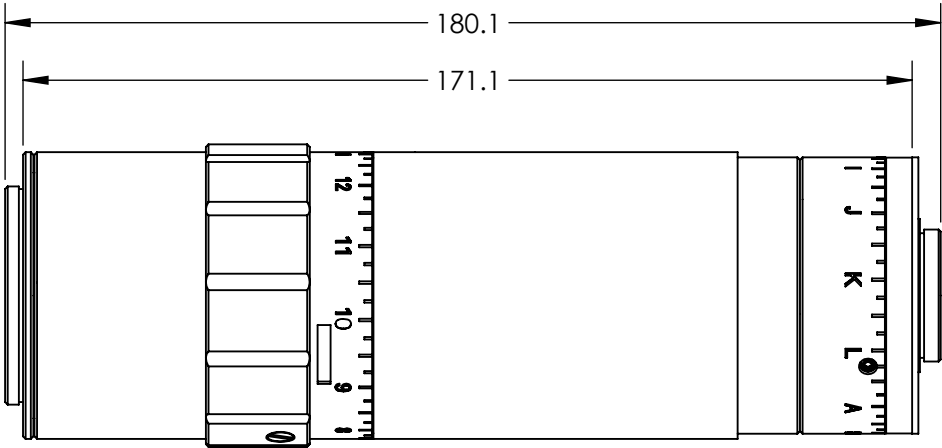

Ø 58.2

**FOR INFORMATION ONLY:
DO NOT MANUFACTURE
PARTS TO THIS DRAWING**

SPECIFICATIONS SUBJECT TO CHANGE WITHOUT NOTICE
DIMENSIONS ARE FOR REFERENCE ONLY

| | |
|----------------------------|--|
| REV. A | |
| DAMAGE THRESHOLD (PULSED) | 10 J/cm ² @ 10ns, 20 Hz, 1064nm |
| DESIGN WAVELENGTH DWL (nm) | 1064 |
| TRANSMISSION | >97.5% @ DWL |
| TRANSMITTED WAVEFRONT, P-V | <λ/7 @ 1064nm for Input Beam ≤5mm |



ALL DIMS IN

mm

Edmund Optics®

TITLE

1064 nm 1X - 3X VARIABLE BEAM EXPANDER

DWG NO

87562

SHEET
1 OF 1