

NOTES:

- 1. SUBSTRATE MATERIAL:  
N-BK7
- 2. COATING (APPLY ACROSS CLEAR APERTURE)  
  
S1 & S2: NIR I  
  
R(avg) ≤0.5% @ 600 - 1050nm

- 3. FINE GROUND SURFACE
- 4. POWER, IRREGULARITY, AND SURFACE QUALITY  
SPECIFICAIONS APPLY ACROSS CLEAR APERTURE
- 5. RoHS COMPLIANT

**FOR INFORMATION ONLY:  
DO NOT MANUFACTURE  
PARTS TO THIS DRAWING**

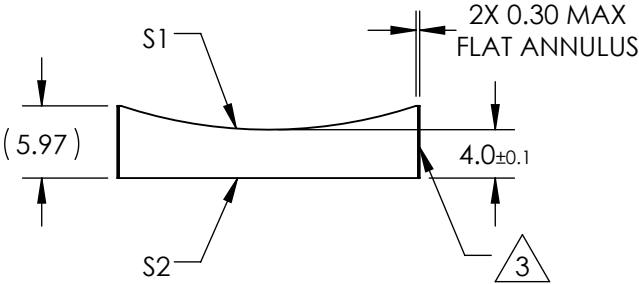
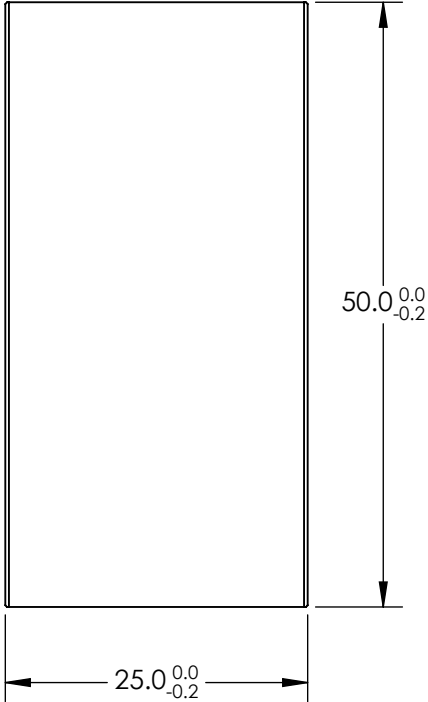

SPECIFICATIONS SUBJECT TO CHANGE WITHOUT NOTICE  
DIMENSIONS ARE FOR REFERENCE ONLY

REV. A	S1	S2	<div>EFL-75</div> <div>BFL-77.6</div> <div><div><div></div><div></div></div><div>Edmund Optics®</div></div>			
SHAPE	CONVEX	PLANO				
RADIUS	38.76	∞	<div>THIRD ANGLE PROJECTION</div> <div><div></div><div></div></div> <div>TITLE</div> <div>25mm H X 50mm L X -75mm FL NIR I COATED, CYLINDER LENS</div>			
SURFACE QUALITY	60-40	60-40				
CLEAR APERTURE	24.00 X 49.00	24.00 X 49.00	<div>ALL DIMS IN</div> <div>mm</div> <div>DWG NO</div> <div>69828</div> <div>SHEET 1 OF 1</div>			
COATING APERTURE	24.00 X 49.00	24.00 X 49.00				
BEVEL	PROTECTED AS NEEDED	PROTECTED AS NEEDED				