

NOTES:

1. SUBSTRATE MATERIAL:  
BOROFLOAT®
2. COATING (APPLY ACROSS CLEAR APERTURE)  
  
S1: NONE  
S2: NONE
3. POWER, IRREGULARITY, SURFACE QUALITY, AND COATING  
SPECIFICATIONS APPLY ACROSS CLEAR APERTURE
4.

FINE GROUND SURFACE
5. ROHS COMPLIANT

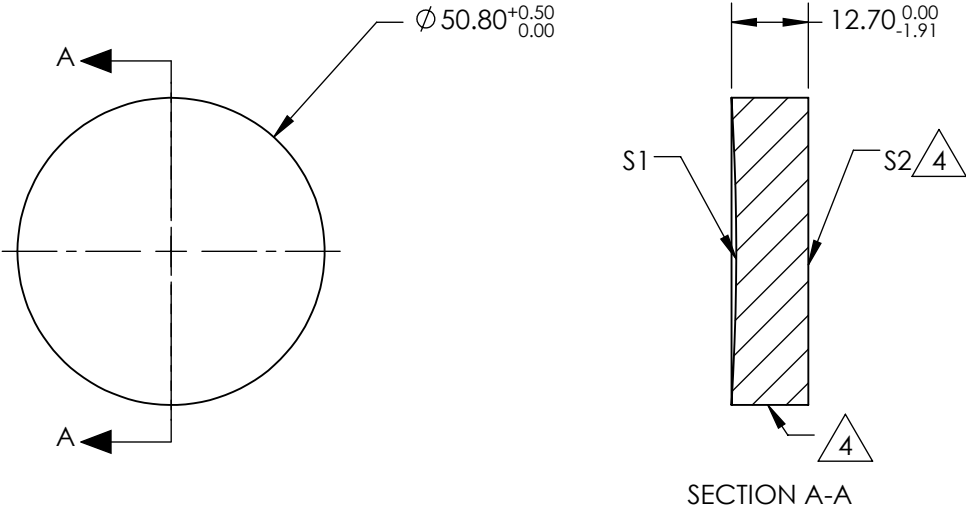

**FOR INFORMATION ONLY:  
DO NOT MANUFACTURE  
PARTS TO THIS DRAWING**

SPECIFICATIONS SUBJECT TO CHANGE WITHOUT NOTICE  
DIMENSIONS ARE FOR REFERENCE ONLY

| REV. A                 | S1                   | S2                   |
|------------------------|----------------------|----------------------|
| SHAPE                  | CONCAVE              | PLANO                |
| EFFECTIVE FOCAL LENGTH | 203.2mm              | N/A                  |
| FOCAL LENGTH TOLERANCE | ±2%                  | N/A                  |
| APERTURE               | f/4                  | N/A                  |
| SURFACE QUALITY        | 60-40                | 60-40                |
| SURFACE FLATNESS       | λ/4                  | λ/4                  |
| BEVEL                  | PROTECTIVE AS NEEDED | PROTECTIVE AS NEEDED |

THIRD ANGLE PROJECTION

ALL DIMS IN

mm

Edmund Optics®

2" Dia, 8" FL Protected Alum., Spherical Mirror

TITLE

DWG NO

49603

SHEET 1 OF 1