

NOTES:

- 1. SUBSTRATE: FUSED SILICA
- 2. PARALLEISM : 30 ARCSEC
- 3. COATING SPECIFICATION:  
  
ENHANCED ALUMINUM  
S1: R(avg) >95% @ 450 - 650nm  
S2: NONE
- 4. POWER, IRREGULARITY, AND SURFACE QUALITY SPECIFICATIONS  
APPLY ACROSS CLEAR APERTURE
- 5. ROHS COMPLIANT

**FOR INFORMATION ONLY:  
DO NOT MANUFACTURE  
PARTS TO THIS DRAWING**

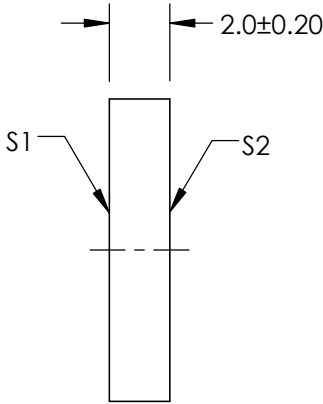
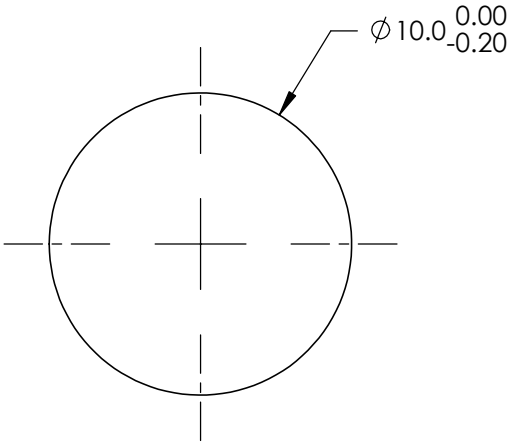
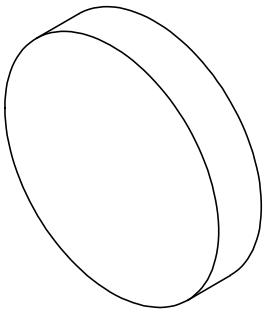

SPECIFICATIONS SUBJECT TO CHANGE WITHOUT NOTICE  
DIMENSIONS ARE FOR REFERENCE ONLY

	S1	S2
SHAPE	PLANO	PLANO
SURFACE QUALITY	20-10	COMMERCIAL POLISH
SURFACE FLATNESS	$\lambda/20$	N/A
BEVEL	PROTECTIVE AS NEEDED	PROTECTIVE AS NEEDED

THIRD ANGLE  
PROJECTION

ALL DIMS IN

mm

**EO<sup>®</sup> Edmund Optics<sup>®</sup>**

TITLE	Ø10mm, $\lambda/20$ , ENHANCED ALUMINUM MIRROR		
DWG NO	34354	SHEET	1 OF 1