

NOTES:

1. SUBSTRATE MATERIAL:  
BOROFLOAT®
2. COATING (APPLY ACROSS CLEAR APERTURE)  
  
S1: NONE  
S2: NONE
3. POWER, IRREGULARITY, SURFACE QUALITY, AND COATING  
SPECIFICATIONS APPLY ACROSS CLEAR APERTURE
4.

 FINE GROUND SURFACE
5. ROHS COMPLIANT

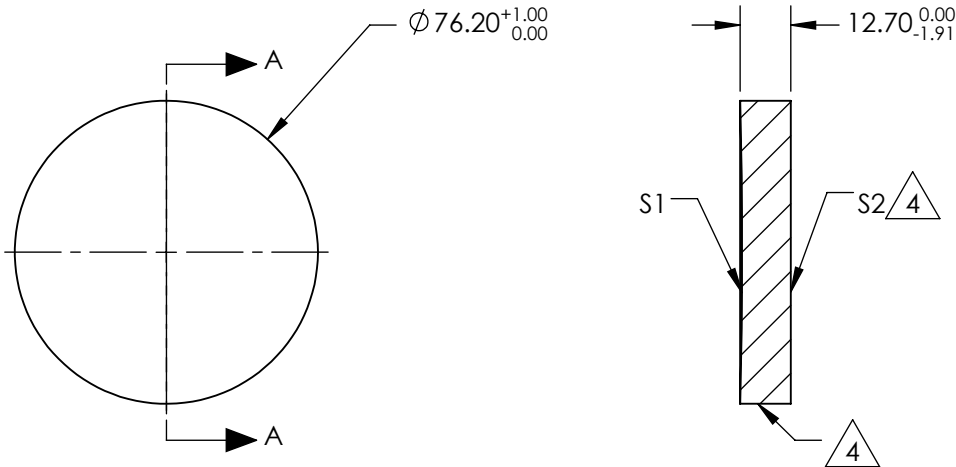

SECTION A-A

**FOR INFORMATION ONLY:  
DO NOT MANUFACTURE  
PARTS TO THIS DRAWING**

SPECIFICATIONS SUBJECT TO CHANGE WITHOUT NOTICE  
DIMENSIONS ARE FOR REFERENCE ONLY

| REV. A                 | S1                   | S2                   |  |  |  |  |
|------------------------|----------------------|----------------------|--|--|--|--|
| SHAPE                  | CONCAVE              | PLANO                |  |  |  |  |
| EFFECTIVE FOCAL LENGTH | 762mm                | N/A                  |  |  |  |  |
| FOCAL LENGTH TOLERANCE | ±2%                  | N/A                  |  |  |  |  |
| APERTURE               | f/10                 | N/A                  |  |  |  |  |
| SURFACE QUALITY        | 60-40                | 60-40                |  |  |  |  |
| SURFACE FLATNESS       | λ/4                  | λ/4                  |  |  |  |  |
| BEVEL                  | PROTECTIVE AS NEEDED | PROTECTIVE AS NEEDED |  |  |  |  |

THIRD ANGLE  
PROJECTION

ALL DIMS IN

mm

Edmund Optics®

TITLE

Ø3in, 30in FL UNCOATED, SPHERICAL MIRROR

DWG NO

32832

SHEET  
1 OF 1