

NOTES:

1. SUBSTRATE
CORNING: FUSED SILICA 458/678
2. ROHS COMPLIANT
3. WAVELENGTH RANGE: 350 - 2200nm
4. COATING (APPLY ACROSS COATING APERTURE)
S1 & S2: UV-VIS
R(AVG) $\leq 1.5\%$ FROM 250-700nm @ 0° AOI
R(ABS) $\leq 1.0\%$ FROM 350-450nm @ 0° AOI

5. FINE GRIND SURFACE
6. POWER, IRREGULARITY, AND SURFACE QUALITY SPECIFICATIONS APPLY ACROSS CLEAR APERTURE
7. IMAGE ORIENTATION: BEAM DEVIATION
8. APPLY ARROW ON EDGE WITH PENCIL OR PERMANENT INK POINTING TOWARDS TILTED SURFACE S2

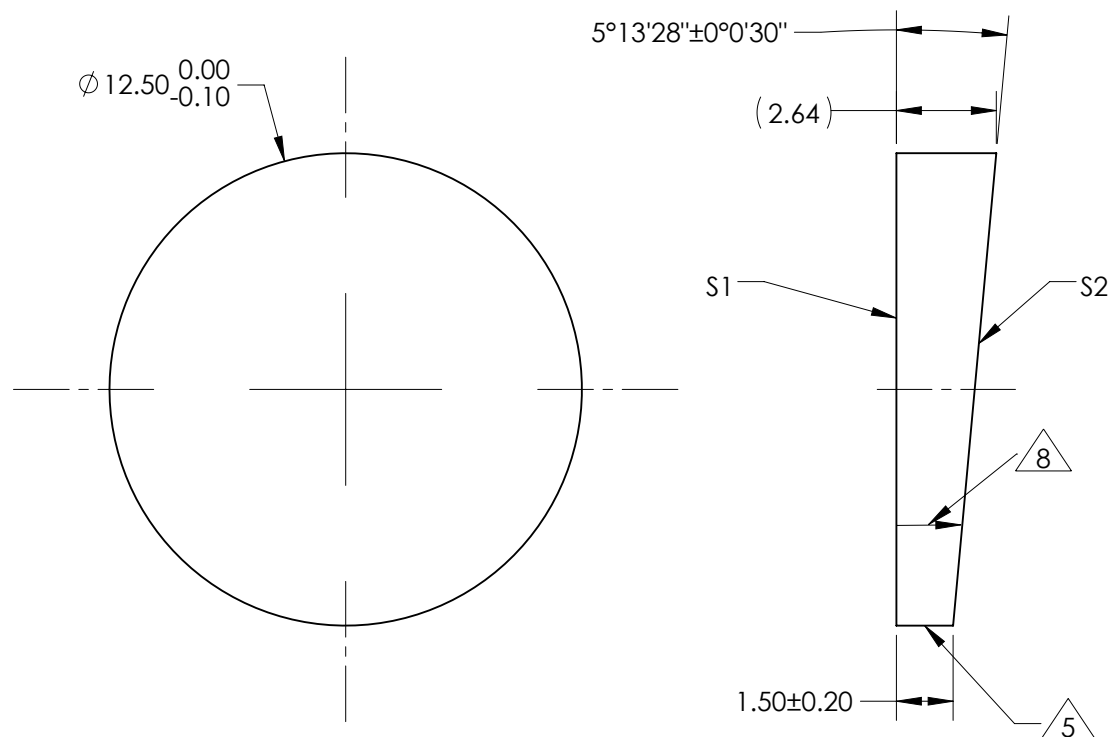

**FOR INFORMATION ONLY:
DO NOT MANUFACTURE
PARTS TO THIS DRAWING**

	S1	S2
SHAPE	PLANO	PLANO
SURFACE QUALITY	20 - 10	20 - 10
MIN CLEAR APERTURE	Ø 11.25	Ø 11.25
MIN COATING APERTURE	N/A	N/A
POWER AT 632.8nm	0.5 RINGS	0.5 RINGS
IRREGULARITY AT 632.8nm	0.2 RING	0.2 RING
BEVEL	PROTECTIVE, AS NEEDED	PROTECTIVE, AS NEEDED

SPECIFICATIONS SUBJECT TO CHANGE WITHOUT NOTICE
DIMENSIONS ARE FOR REFERENCE ONLY

Edmund Optics®

TITLE	PRISM WEDGE FS 2.5 DEG 12.5MM UV VIS
DWG NO	35853
SHEET	1 OF 1

THIRD ANGLE
PROJECTION



ALL DIMS IN

mm