

NOTES:

1. SUBSTRATE
CORNING: FUSED SILICA 458/678
2. ROHS COMPLIANT
3. WAVELENGTH RANGE: 350 - 2200nm
4. COATING (APPLY ACROSS COATING APERTURE)

S1 & S2: UV-VIS
 $R(AVG) \leq 1.5\%$ FROM 250-700nm @ 0° AOI
 $R(ABS) \leq 1.0\%$ FROM 350-450nm @ 0° AOI

5. FINE GRIND SURFACE
6. POWER, IRREGULARITY, AND SURFACE QUALITY SPECIFICATIONS APPLY ACROSS CLEAR APERTURE
7. IMAGE ORIENTATION: BEAM DEVIATION
8. APPLY ARROW ON EDGE WITH PENCIL OR PERMANENT INK POINTING TOWARDS TILTED SURFACE S2

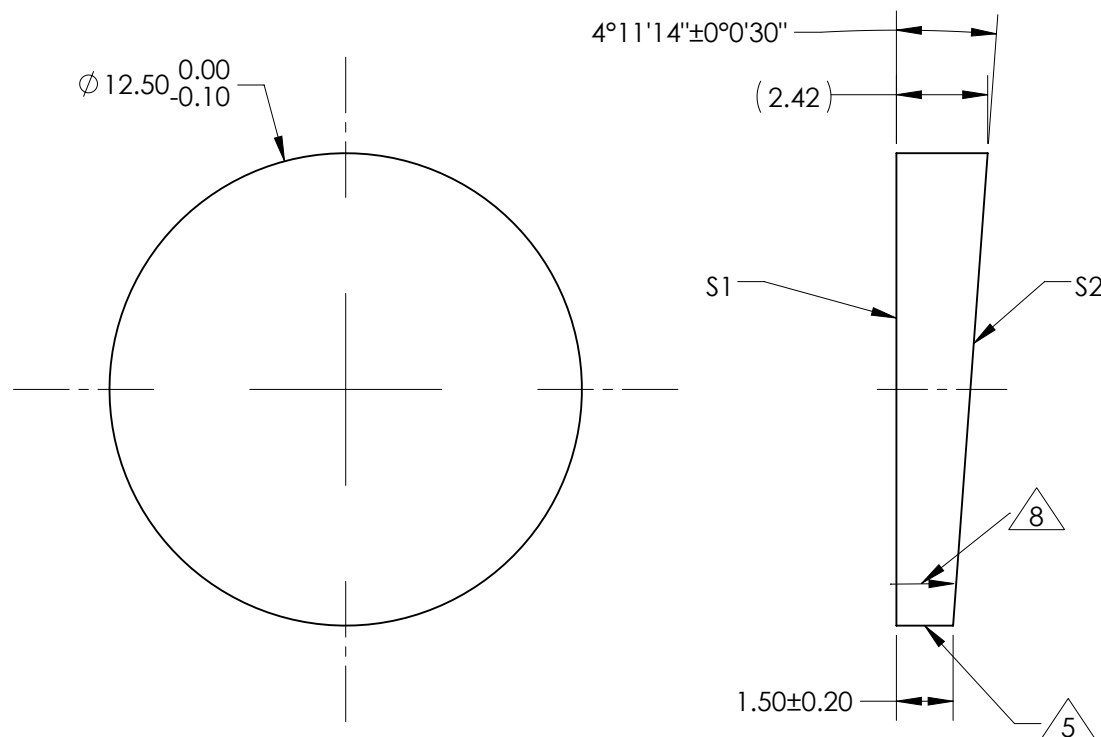

FOR INFORMATION ONLY:
DO NOT MANUFACTURE
PARTS TO THIS DRAWING

	S1	S2
SHAPE	PLANO	PLANO
SURFACE QUALITY	20 - 10	20 - 10
MIN CLEAR APERTURE	$\phi 11.25$	$\phi 11.25$
MIN COATING APERTURE	N/A	N/A
POWER AT 632.8nm	0.5 RINGS	0.5 RINGS
IRREGULARITY AT 632.8nm	0.2 RING	0.2 RING
BEVEL	PROTECTIVE, AS NEEDED	PROTECTIVE, AS NEEDED

SPECIFICATIONS SUBJECT TO CHANGE WITHOUT NOTICE
DIMENSIONS ARE FOR REFERENCE ONLY

EO® **Edmund Optics**®

THIRD ANGLE
PROJECTION



ALL DIMS IN

mm

TITLE

PRISM WEDGE FS 2 DEG 12.5MM UV VIS

DWG NO

35852

SHEET
1 OF 1