

NOTES:

- 1. SUBSTRATE:  
GRADE A FINE ANNEALED
- ②. COATING (APPLY ACROSS COATING APERTURE)  
NONE  
NONE
- 3. CENTERING TOLERANCE (AT 587.6nm):  
PLANO AXIS WEDGE: < 5 ARCMIN  
POWER AXIS WEDGE: < 5 ARCMIN  
AXIAL TWIST: < 3 ARCMIN
- △. FINE GRIND SURFACE
- 5. POWER, IRREGULARITY, AND SURFACE QUALITY  
SPECIFICATIONS APPLY ACROSS CLEAR APERTURE
- 6. FOCAL LENGHT (EFL): 25.00nm  
BACK FOCAL LENGTH (BFL): 17.39nm
- 7. RoHS COMPLIANT

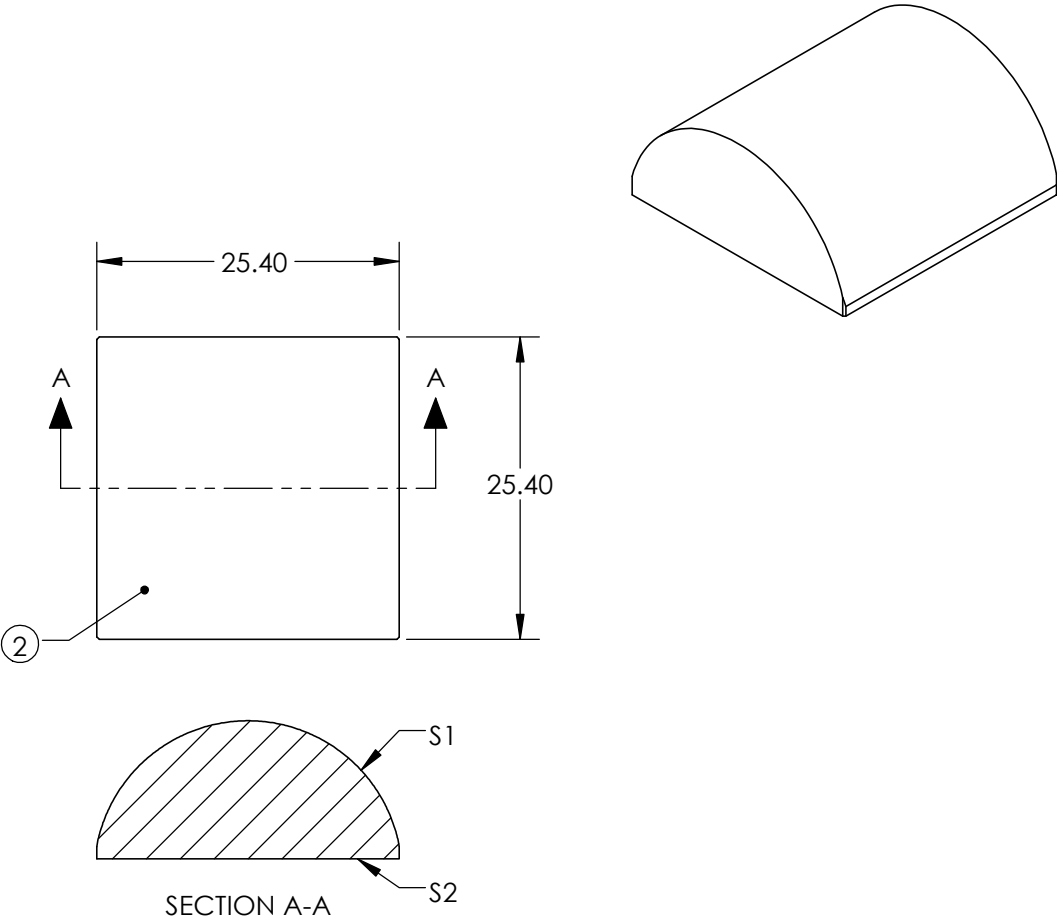

**FOR INFORMATION ONLY:**  
**DO NOT MANUFACTURE**  
**PARTS TO THIS DRAWING**

SPECIFICATIONS SUBJECT TO CHANGE WITHOUT NOTICE  
DIMENSIONS ARE FOR REFERENCE ONLY

	S1	S2	<div><div><div><div></div></div></div><div><div></div></div><div>Edmund Optics®</div></div>			
SHAPE	CONVEX	PLANO	<div><div>THIRD ANGLE PROJECTION</div><div><div><div></div></div><div><div></div></div></div><div>TITLE</div><div>LENS PCX CYLINDER 25.40mm x 25.40mm x 25.00mm EFL</div></div>			
SURFACE QUALITY	40 - 20	40 - 20				
CLEAR APERTURE	Ø22.86 x 22.86	Ø22.86 x 22.86	<div><div>ALL DIMS IN</div><div>mm</div><div>DWG NO</div><div>34753</div><div>SHEET 1 OF 1</div></div>			
BEVEL	PROTECTIVE AS NEEDED	PROTECTIVE AS NEEDED				